



T300 Models

Lid Hinge Retrofit Kit



NOTICE: This retrofit kit is intended for T300 machines manufactured in USA before serial number 10743606. The original lid hinge brackets have been discontinued and replaced by this retrofit kit. Install the retrofit kit as illustrated below. This retrofit kit is also available for T300e and Speed Scrub 300 models that are equipped with rubber strap hinges.

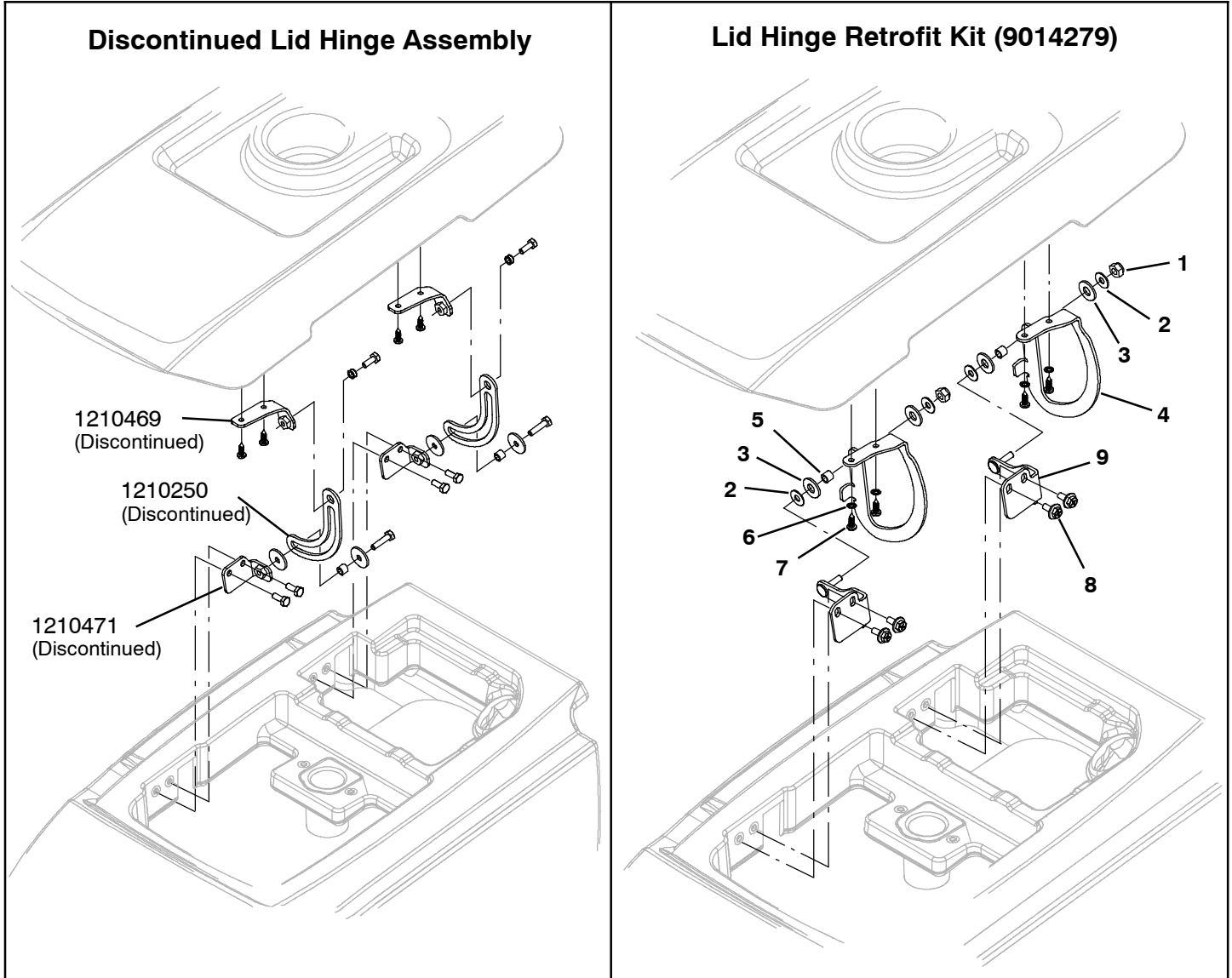

Lid Hinge Retrofit Kit Parts List

Ref.	Part No.	Description	Qty.
	9014279	Kit, Retrofit Lid Hinge	1
1	08712	Nut, Hex, Lock, M6 X 1.00, NI, Ss	2
2	01684	Washer, Flat, 0.27b 0.69d .05, Ss	4
3	01685	Washer, Flat, 0.38b 0.88d .08, Ss	4
4	1219440	Hinge, Goose Neck	2
5	140154	Sleeve, P/M, 0.25b 0.38d 0.3l, PI	2
6	07514	Washer, Lock, Int, 10, Ss	4
7	1018155	Screw, Pan, Phl, M5 X 0.80 X 16, Tcut, Ss	4
8	1034731	Screw, Hex, M6 X 1.00 X 16, Sems, Ss	4
9	1219473	Hinge, Mount, Wldt	2

Please keep this sheet with your owner's manual for future reference.